

FRONT ELEVATION
SCALE 3/32" : 1'

3/7/17

U1201-IA-65.375-NR-RC

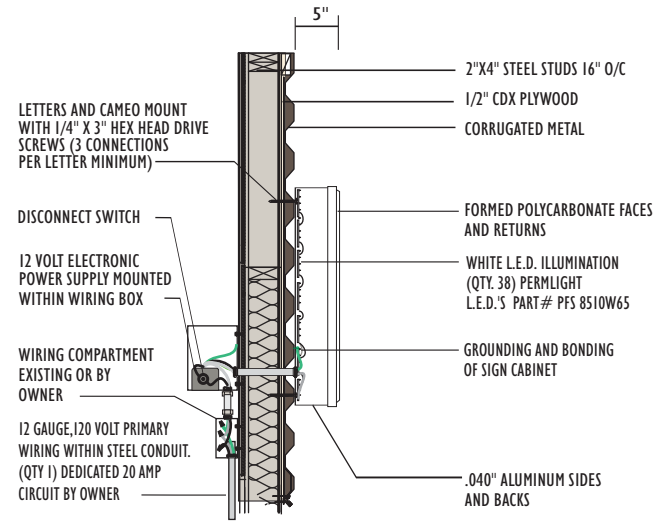
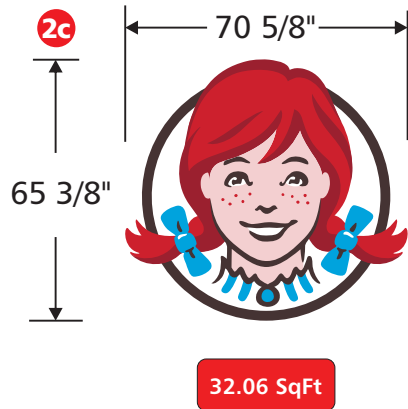

SECTION/MOUNTING DETAILS

ALL WIRING MEETS NEC 2014 SPECIFICATIONS.
SIGN TO BE WIRED TO A STANDARD 120 VOLT / 20 AMP CIRCUIT.

THIS SIGN IS INTENDED TO BE INSTALLED IN ACCORDANCE WITH THE REQUIREMENTS OF ARTICLE 600 OF THE NATIONAL ELECTRICAL CODE AND/OR OTHER APPLICABLE LOCAL CODES. THIS INCLUDES PROPER GROUNDING AND BONDING OF THE SIGN.



SIGN TYPE	SPECIFICATIONS	COLORS	SIGN SURVEY	ARTWORK
<input checked="" type="checkbox"/> SINGLE FACE <input checked="" type="checkbox"/> ILLUMINATED <input checked="" type="checkbox"/> WALL	-.040" ALUMINUM SIDES AND BACKS PAINTED 313 DARK BRONZE - "WENDY'S" - EMBOSSED #7328 WHITE POLYCARBONATE FACES WITH WHITE L.E.D. ILLUMINATION - CAMEO - FORMED POLYCARBONATE FACE WITH PRINTED GRAPHICS SECOND SURFACE WITH WHITE LED ILLUMINATION.	<input checked="" type="checkbox"/> 313 DARK BRONZE <input checked="" type="checkbox"/> 7328 WHITE POLYCARBONATE <input checked="" type="checkbox"/> WHITE <input checked="" type="checkbox"/> PMS 186 RED HAIR <input checked="" type="checkbox"/> PMS 201 BURGUNDY HAIR <input checked="" type="checkbox"/> PMS 299 BLUE <input checked="" type="checkbox"/> PMS 698 PINK <input checked="" type="checkbox"/> PMS 439 BROWN	<input type="checkbox"/> FACE TRIMS <input type="checkbox"/> FASCIA COLOR <input type="checkbox"/> RADIUS DIM. <input type="checkbox"/> BUILDING DIM. <input type="checkbox"/> FACADE ANGLE <input type="checkbox"/> OTHER	<input checked="" type="checkbox"/> PROVIDED <input type="checkbox"/> REQUIRED If required, customer to provide Custom Sign Center, Inc. with camera ready or appropriate digital file. Please contact your salesperson or Design Staff for appropriate file types.

FILENAME: U1201-IA-65.375-NR-RC **REV#** **SCALE:** 1/4" = 1' **Approval Signatures Required** to insure that all spelling, colors, and specifications for sign(s) rendered meets customer & landlord approvals. **CUSTOMER:** _____ **LANDLORD:** _____
DATE: 4/14/16 **REV.DATE:** **DGNR:** THW **SALES:** T. SHEEHY **DATE:** _____ **DATE:** _____

This original design and all information herein are the property of Custom Sign Center, Inc. Artwork is subject to return if not purchased. Any unauthorized use is forbidden. © Copyright 2007 All rights reserved.